

CPF

平行油壓轉角缸

CPF HYDRAULIC SWING CLAMP



產品特性

此系列產品配件採用優化設計,使體積更加緊湊,提高了產品強度。產品採用了專用防塵設計,提高了防塵和密封性,實現了高密封性。
產品平行轉角設計節省了空間,適合夾具要求的緊湊化。

最大操作壓力: 45 kgf/cm²
最小操作壓力: 20 kgf/cm²
作動方式: 複動式

FEATURES

This series product with the optimal design,so made more compact,and strength can be improved. Product with special dust proof design,dust proof and sealing have been improved,so it has high sealing performance.
Product parallel angle clamp design saves space,more suitable for compact fixture.

Max. operating pressure: 45 kgf/cm²
Min. operating pressure: 20 kgf/cm²
Double acting

剖面圖 Sectional view

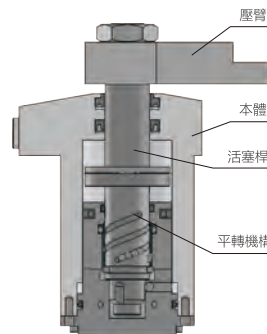

注意事項

夾緊及放鬆作動速度需適當放緩。
特殊壓臂長度及重量不得超過標準壓臂的1.5倍。
壓臂旋轉示意圖及安裝拆卸方式,請參見第4頁。

NOTE

The acting speed of clamping-unclamping should be slowed down.
For customized clamp arm, please don't exceed 1.5 times of the original length and weight.
The methods to mount & remove and the rotation diagram of the clamp arm, please refer to page 4.

訂購標示法 ORDERING INDICATION

示例: CPF-35DL-90G

CPF	系列 Series	CPF
35	油缸內徑 Hydraulic cylinder inside diameter	Φ35, Φ40
D	安裝方式 Installation	U:上法蘭安裝 On flange installation D:下法蘭安裝 Base flange installation
L	轉角方向 Swing direction	右轉R或左轉L Turn right R or turn left L
90	轉角角度 Swing angle	標準角度 Standard angle 90°(±2°) 訂做角度 Order angle 0°, 45°(±2°), 60°(±2°)
G	型式 Type	空白: 配管式 Line type G: 油路板型 Manifold type

備註: 選配調速閥為CZL系列

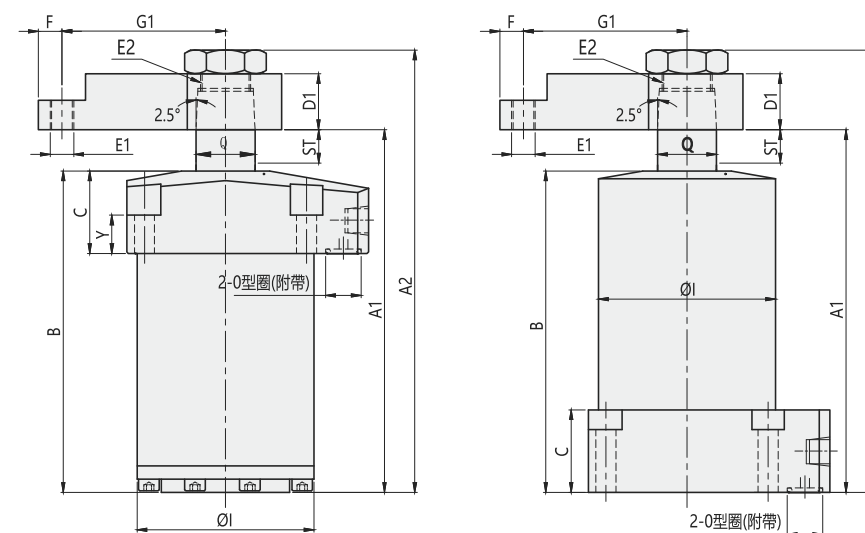
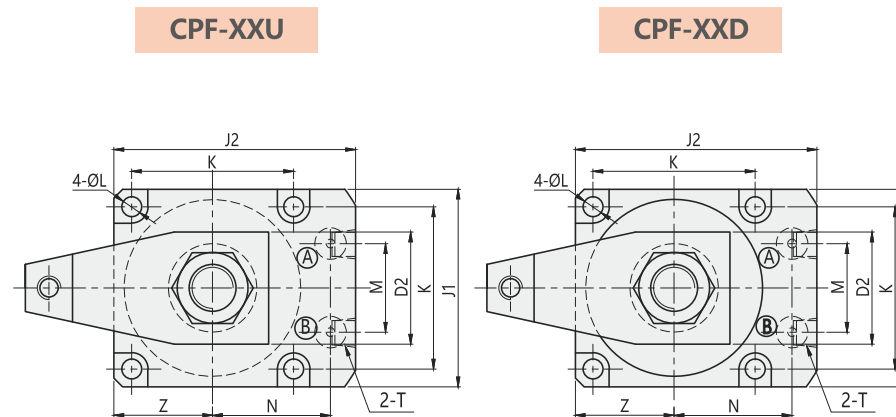
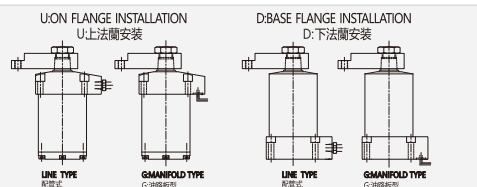

- Ⓐ 夾持油孔 Clamping port
- Ⓑ 放鬆油孔 Unclamping port

Unit:mm

MODEL ITEM	CPF-35U	CPF-40U	CPF-35D	CPF-40D
行程Stroke	10	10	10	10
A1鬆開狀態 Unclamp	114	123	114	123
A2鬆開狀態 Unclamp	141	150	141	150
B	96	109	96	109
C	28	28	28	28
D1	19	19	19	19
D2	38	38	38	38
E1	M6	M8	M6	M8
E2	M16X1.5	M16X1.5	M16X1.5	M16X1.5
F	6	8	6	8
G1	46.5	55.5	46.5	55.5
I	Φ50	Φ60	Φ50	Φ60
J1	59	67	59	67
J2	72	82	72	82
K	47	55	47	55
L	Φ6.8	Φ6.8	Φ6.8	Φ6.8
M	24	30	24	30
N	34	40	34	40
T	PT1/8	PT1/8	PT1/8	PT1/8
Y	16	16	16	16
Z	29.5	33.5	29.5	33.5
Q	Φ20	Φ20	Φ20	Φ20
O-Ring	P6	P9	P6	P9

規格參數表 SPECIFICATION

型號	理論夾持力 (45 kgf/cm ²)	夾緊行程	總行程	推出容積	拉入容積	推出受壓面積	拉入受壓面積	使用溫度範圍	使用流體
MODEL	CLAMPING FORCE AT 45 kgf/cm ² (kgf)	CLAMPING STROKE (mm)	TOTAL STROKE(mm)	CYLINDER CAPACITY UNCLAMP(cm ³)	CYLINDER CAPACITY CLAMP(cm ³)	EFFPISTON AREA UNCLAMP(cm ²)	EFFPISTON AREA CLAMP(cm ²)	RANGE OF TEMPERATURE(°C)	USABLE FLUID
CPF-35	291	10	10	6.47	6.47	6.47	6.47	-10~+70°C	相繼於ISO黏度等級的ISO-VG-32一般液壓油 General Hydraulic Oil Equivalent to ISO-VG-32
CPF-40	424	10	10	9.43	9.43	9.43	9.43	-10~+70°C	